

Description:

The needle valves – type NV – are used as shut-off and regulating devices in pipelines. Their installation requires 90 deg. bend in the pipeline. NV valves can be used for fluid and gaseous service for temperature up to 150°C. NV valves have following advantages:

- 100% tightness
- high pressure ratings available – up to 160 bar,
- compact style and low weight,
- metallic, very long – life main seal,
- easy to operate (manually and electrically),
- maintenance free, no lubrication points,
- high quality and durability, confirmed by successful installations.

Main materials:

Parts	Type standard
Body I	carbon steel, (option - stainless steel)
Spindle	Chromium steel
Bearings	slide bushing steel-bronze - PTFE
Soft seals	Novothan / Buna N
Needle	Chromium steel
Body II	carbon steel, (option - stainless steel); seat ring overlaid with stainless steel

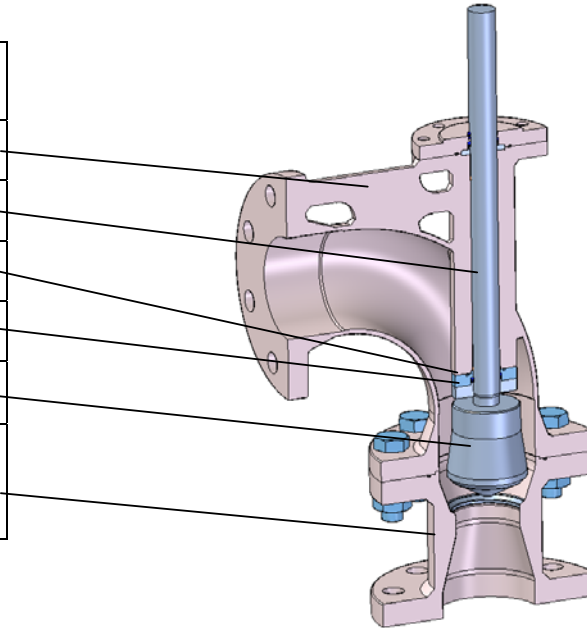

Equivalents to above materials can be provided. Other materials, pressure ratings and temperatures are available upon request. Standard corrosion protection – hot dip zinced.

General design:

1. Electric actuator

2. Double acting servomotor

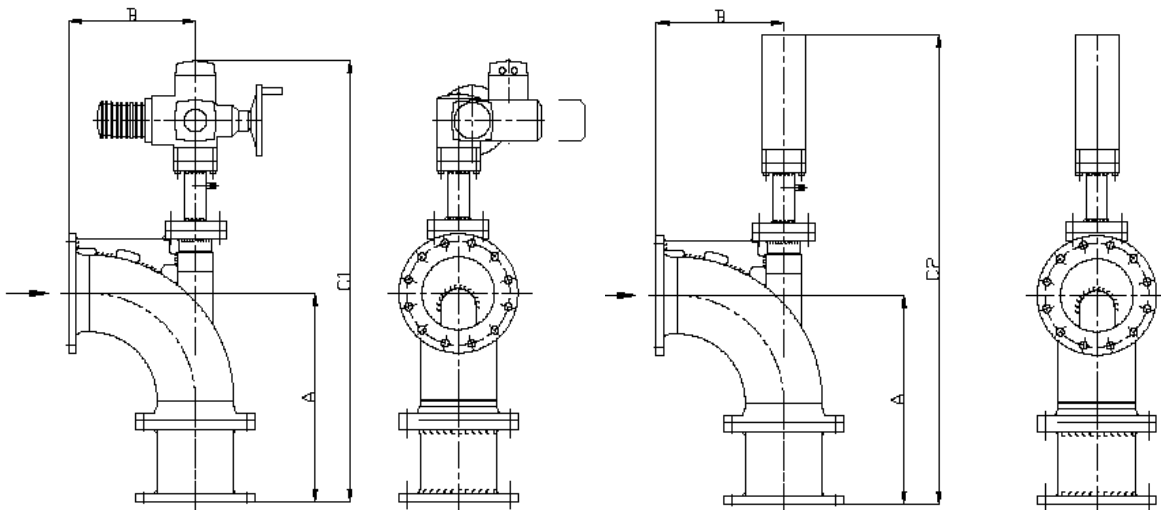



www.tfvalves.com

Needle valve Type NV DN65(2,5'')-300(12'') PN6-160

Dimensions + weights for standard range of NV Needle valves (other sizes and pressure rates on request).

DN	PN6					PN10					PN16					PN25					PN40					PN64				
	A	B	C1	C2	Weight drive 1	A	B	C1	C2	Weight drive 1	A	B	C1	C2	Weight drive 1	A	B	C1	C2	Weight drive 1	A	B	C1	C2	Weight drive 1	A	B	C1	C2	Weight drive 1
[mm]	[mm]	[mm]	[mm]	[mm]	[kg]	[mm]	[mm]	[mm]	[mm]	[kg]	[mm]	[mm]	[mm]	[mm]	[kg]	[mm]	[mm]	[mm]	[mm]	[kg]	[mm]	[mm]	[mm]	[mm]	[kg]	[mm]	[mm]	[mm]	[mm]	[kg]
65	295	129				301	135				301	135				309	143				309	143				306	140			
80	329	153				337	161				337	161				345	169				345	169	950		170	339	163	950		180
100	379	193				387	201				387	201				400	214				400	214	1050		180	375	189	1000		190
125	431	235				438	242				438	242				451	255				451	255	1100		200	433	237	1100		220
150	479	273				486	280				486	280	1150		180	506	300	1150		190	506	300	1200		250	488	282	1200		280
200	581	355				589	363	1250		180	589	363	1300		200	607	381	1300		220	615	389	1350		300	571	345	1350		320
250	681	437	1400		180	689	445	1400		210	691	447	1400		230	701	457	1450		280	726	482	1500		330	670	426	1500		370
300	777	513	1500		200	784	520	1500		230	794	530	1500		250	805	541	1600		300	831	567	1700		400	856	592			

Flange in accordance with ISO / DIN.

Flanges in accordance with ANSI and MSS available on request.

Dimensions and weights are preliminary only and are subject to change during detail design.